

The intended use of the welding positioner is to ensure that the job is positioned appropriately for welding. Welding positioners are equipment specifically designed to securely hold, tilt, and rotate industrial workpieces, such as flanges and pipes, through a full 360 degrees. This enables the operator to work at an optimal position and on a stable surface. The table (disk) of the positioner features channels and holes which allow for the secure fixation of various products, including pipes, molds, or flanges of different sizes.

One of the key benefits of utilizing a welding positioner is its ability to accommodate workpiece angulations that would not be feasible with a crane. Therefore, weld positioners are extensively employed within metal fabrication industries for shaping metal parts or components.

Depending on customer requirements, the welding positioner can be utilized either individually or in combination with welding manipulators or pipe supports.

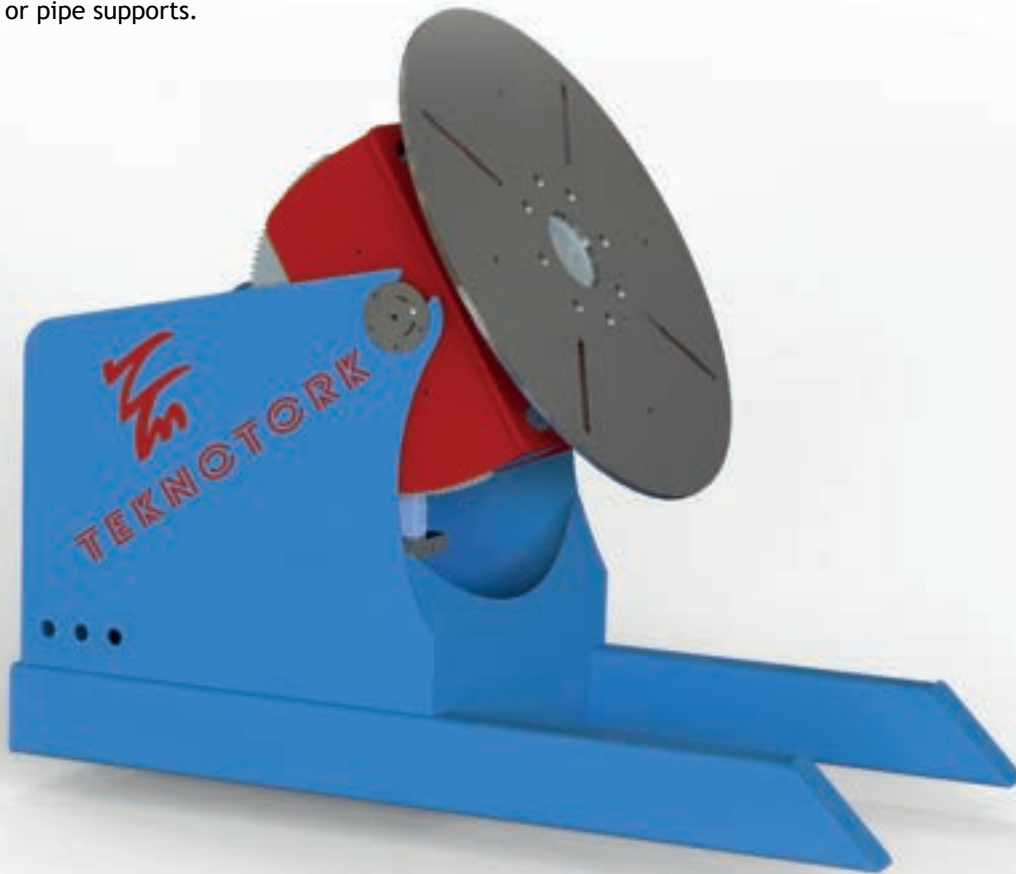

STANDARD FEATURES

- Pendant controller with 5m cable.
- Digital speed indicator on the pendant control for monitoring rotation.
- Table rotating speed control.
- Double foot pedal for left-right turning.
- Machined table with M16 holes and T type slots for fixing workpiece.
- Adjustable drive speed.
- AC drive for rotation and tilt.

OPTIONAL FEATURES

- 3-jaw chuck on table.
- 7' touchscreen.
- Wireless remote controller.
- High accuracy reducer no backlash with servo motor.
- Hydraulic clamping chuck.
- Synchronous operation with column & boom.
- Additional slots and holes on the table.
- Custom-made according to requirements.
- Ground Capacity: 200 Amp, 400 Amp, 800 Amp



GEAR TILT POSITIONER

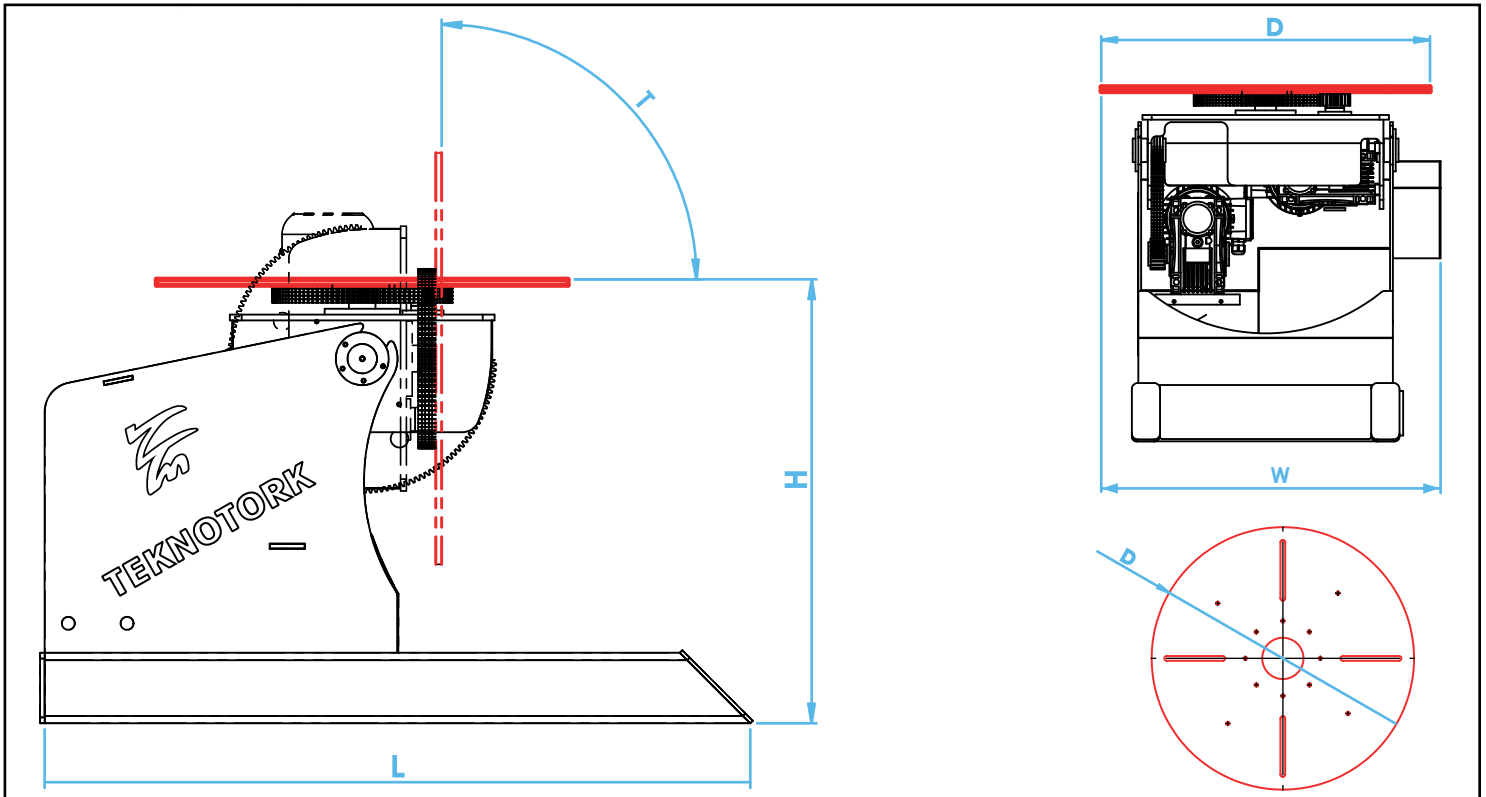

| MODEL | TTMPOZ-500 | TTMPOZ-1 | TTMPOZ-3 | |
|-----------------------------|--------------|--------------|--------------|------|
| Load Capacity (kg) | 500 | 1 000 | 3 000 | |
| Table Turning Capacity (kg) | 500 | 1 000 | 3 000 | |
| Eccentricity (mm) | 150 | 150 | 150 | |
| Center of Gravity (mm) | 150 | 150 | 150 | |
| Table Size (mm) | D | 700 | 1150 | 1250 |
| Tilting Angle (°) | T | 90° | 90° | 90° |
| Turning Speed (rpm) | 0,2 - 2 | 0,15 - 1,5 | 0,1 - 1 | |
| Welding Current (A) | 400 | 600 | 600 | |
| Input Power | 380V 3P 50Hz | 380V 3P 50Hz | 380V 3P 50Hz | |
| Overall Width (mm) | W | 700 | 1150 | 1250 |
| Overall Height (mm) | H | 750 | 1150 | 1250 |
| Overall Length (mm) | L | 1150 | 1850 | 2000 |
| Weight (kg) | 450 | 1450 | 1850 | |

* Capacities and sizes can be customized according to customer requirements.

* All products, features and data are subject to change without notice to improve reliability, function or design.